

LOC		DIST		REVISIONS			
P	LTR	DESCRIPTION	DATE	DWN	APVD		
D1		REVISED PER ECO-11-004835	11MAR11	RK	HMR		

1. MATERIAL:  
 HOUSING – POLYESTER MOLDING COMPOUND, COLOR: BLACK  
 TERMINALS – 0.35[.0138] THICK PHOS BRONZE PLATED WITH 1.27μm[.000050] MIN THICK GOLD IN LOCALIZED AREA AND 3.81μm[.000150] MIN THICK MATTE TIN IN SOLDER AREA OVER 1.27μm[.000050] MIN THICK NICKEL UNDERPLATE  
 SHIELD – COPPER ZINC ALLOY PLATED WITH 3.0μm [.000120] MIN THICK REFLOWED TIN.

$\triangle$  CAVITY CONFORMS TO FCC RULES AND REGULATIONS PART 68 AND REA BULLETIN 345-81, PE-76 SPECIFICATION FOR MODULAR TELEPHONE HARDWARE.

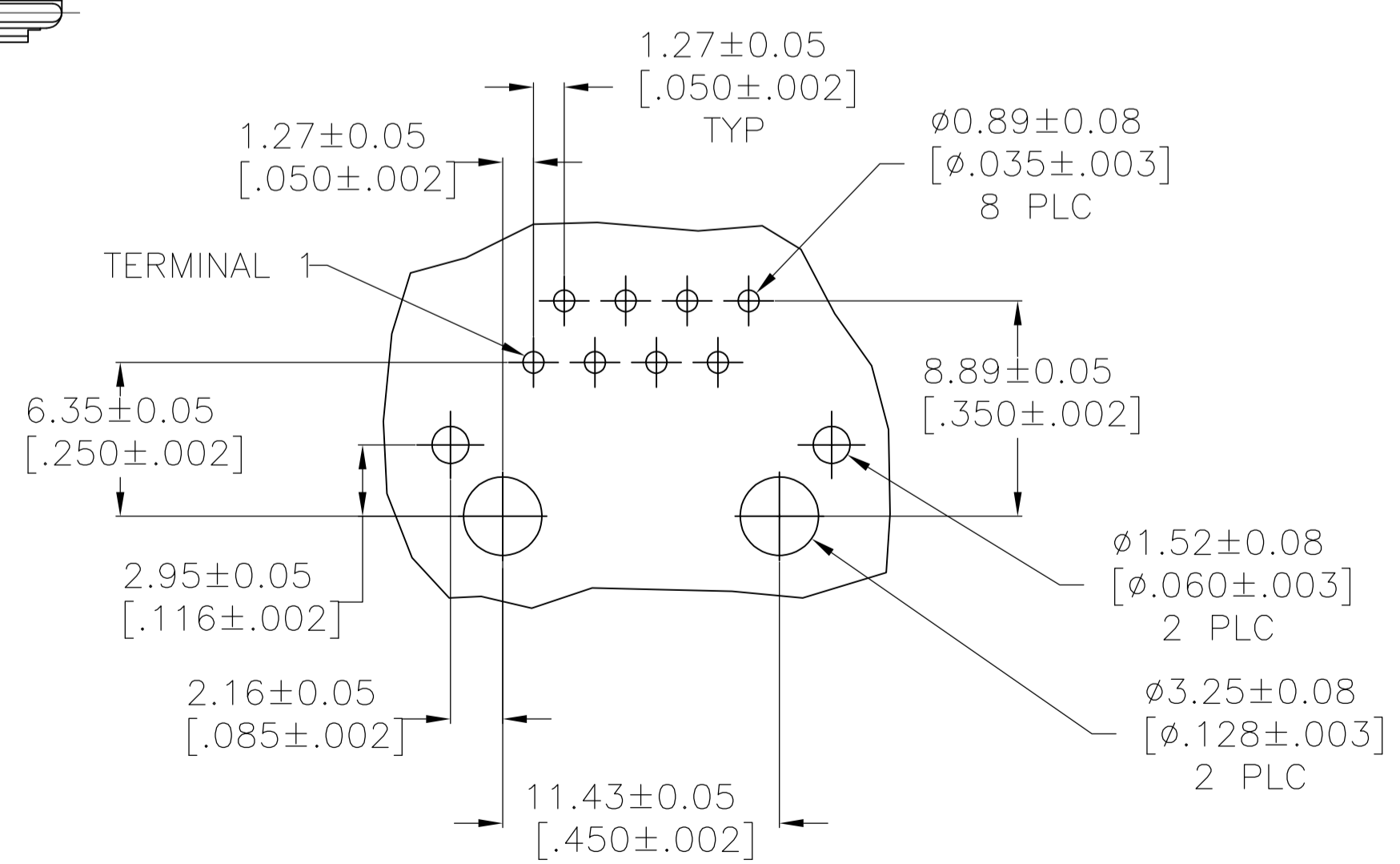
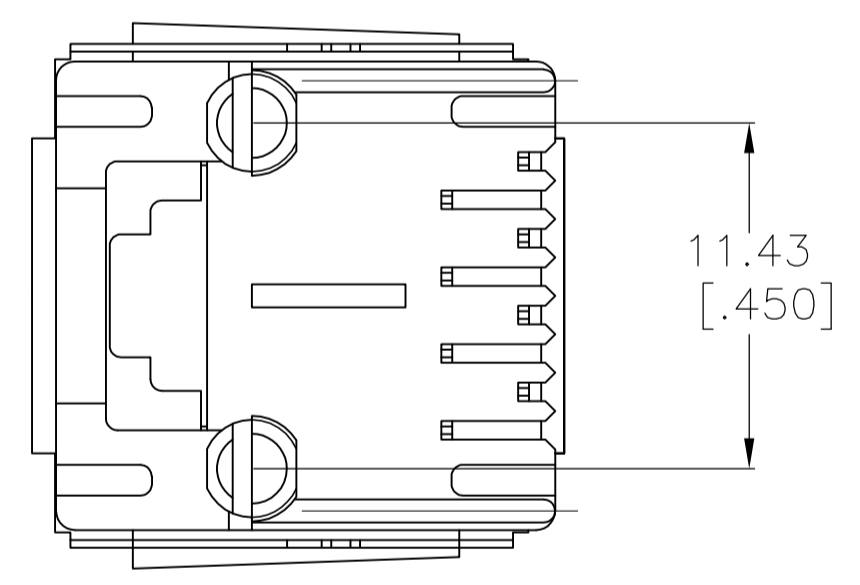
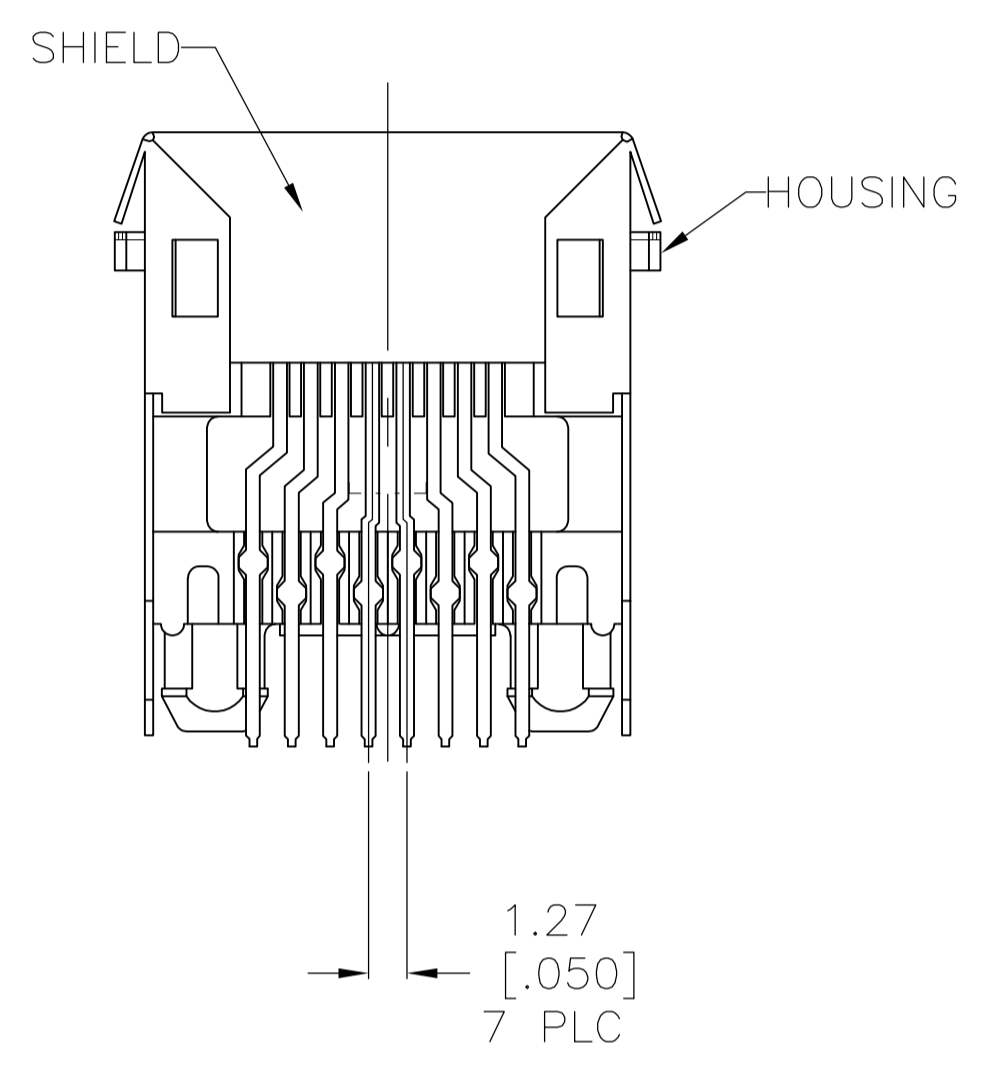
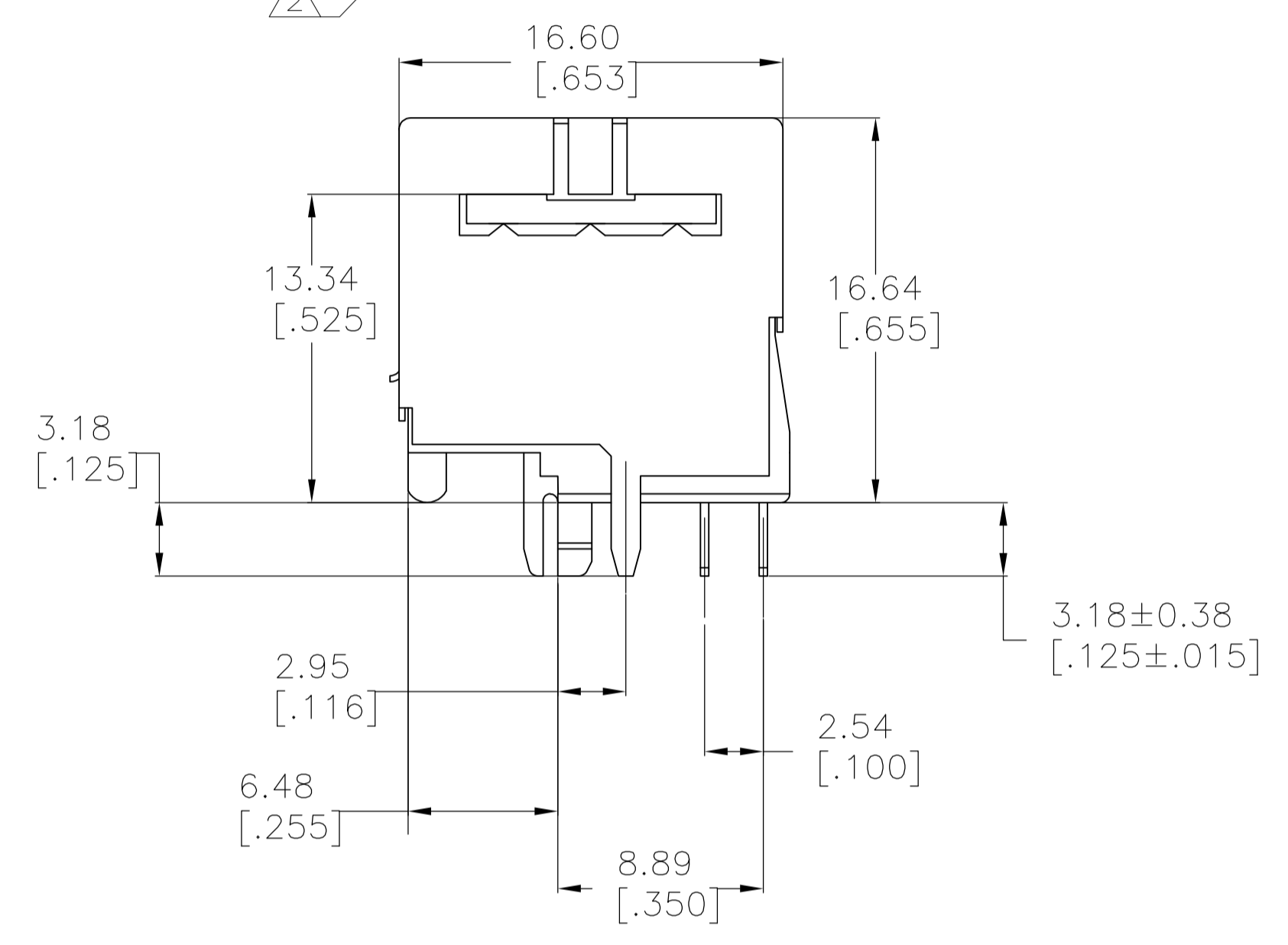
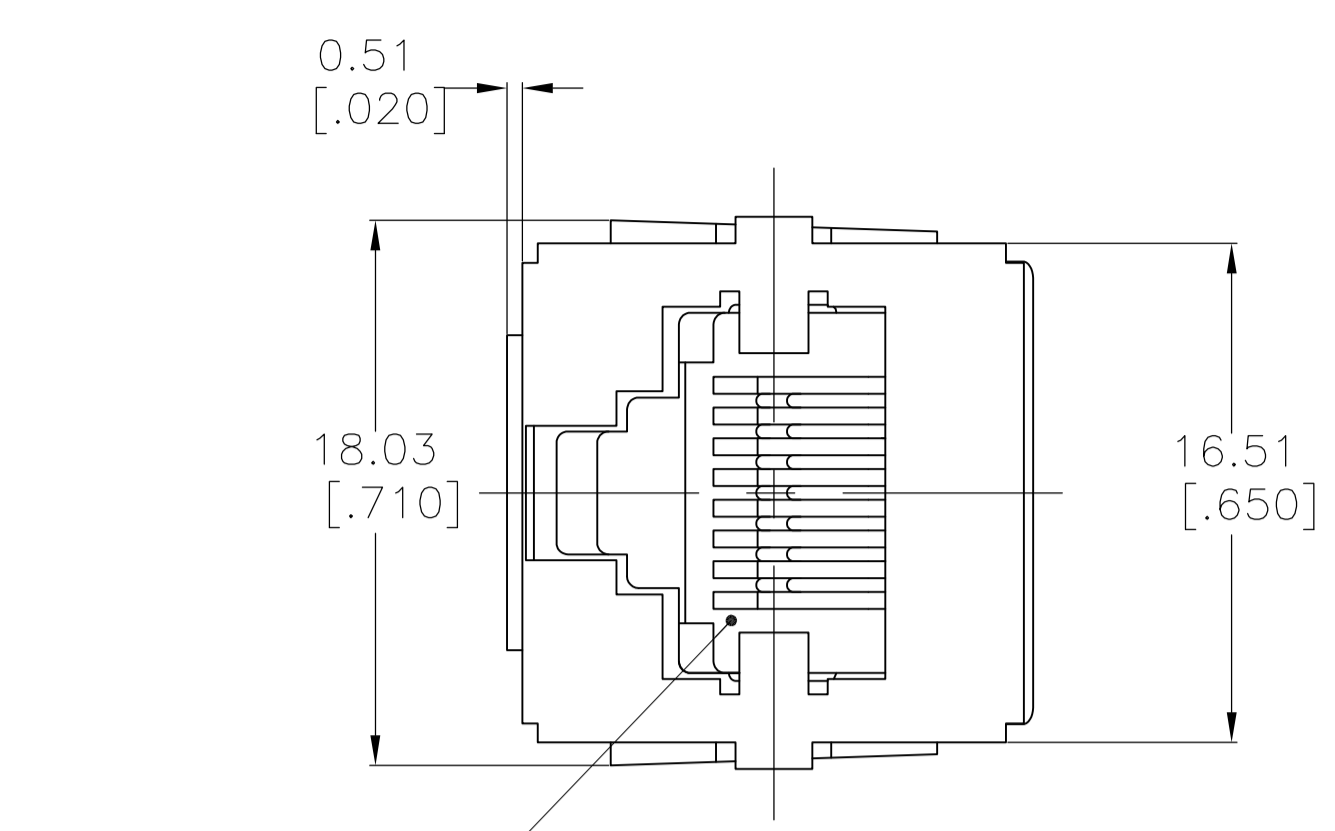

RECOMMENDED PRINTED CIRCUIT BOARD LAYOUT COMPONENT SIDE SHOWN

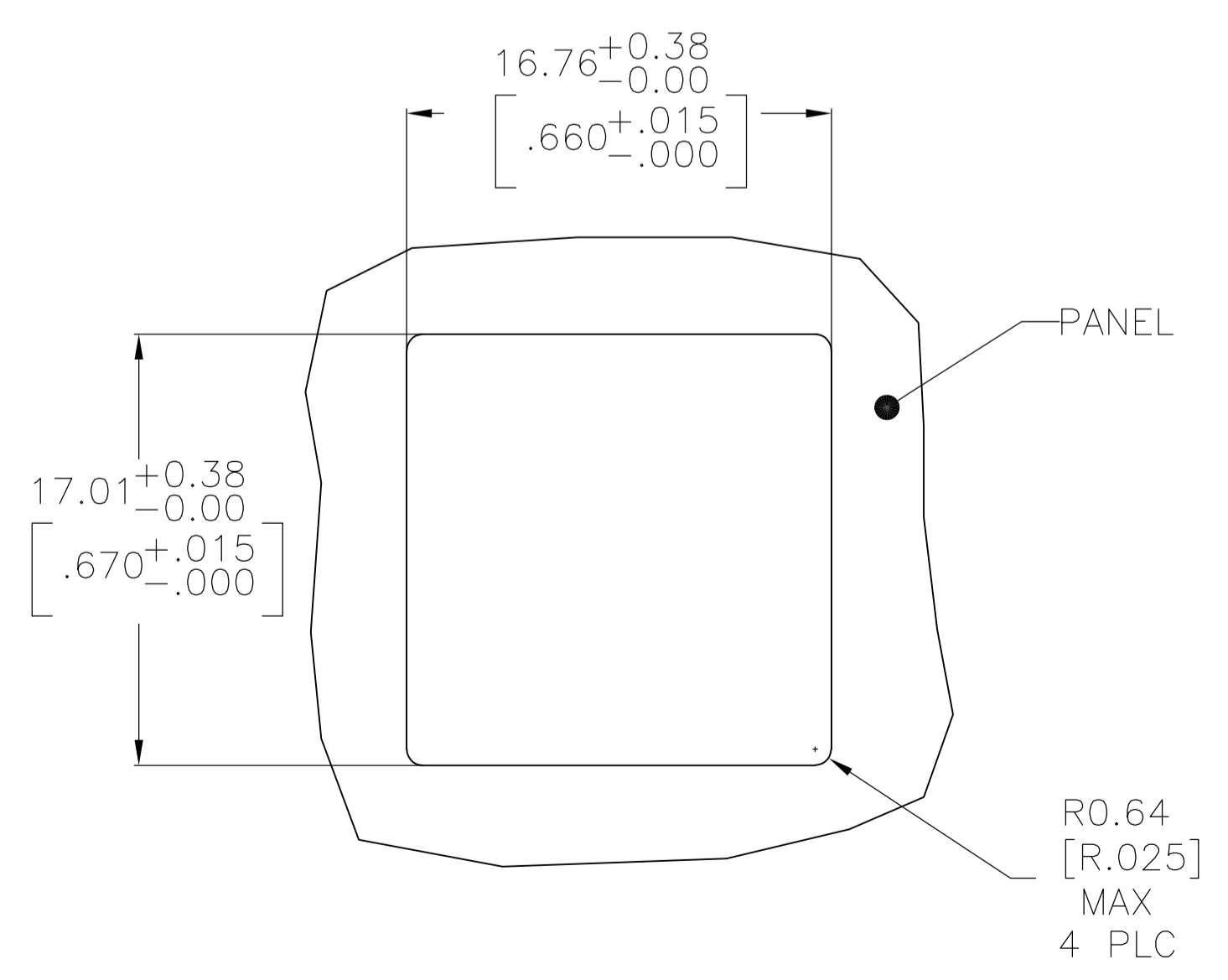

RECOMMENDED PANEL CUTOUT

5406436-1  
PART NO.

THIS DRAWING IS A CONTROLLED DOCUMENT.		DIN J. ALCORTA - 09JUN2005	STE TE Connectivity	
DIMENSIONS: mm [INCHES]		CHK J. WESTMAN 09JUN2005	APVD S. FLICKINGER 09JUN2005 NAME	
TOLERANCES UNLESS OTHERWISE SPECIFIED:		PRODUCT SPEC 108-1163		
0 PLC ± -		APPLICATION SPEC 114-2048		
1 PLC ± -		SIZE CAGE CODE DRAWING NO		
2 PLC ± 0.13[.005]		A1 00779 5406436		
3 PLC ± -		WEIGHT -		
4 PLC ± -		CUSTOMER DRAWING		
ANGLES ± -		SCALE 4:1 SHEET 1 OF 1 REV D1		